



Protecting you and your family from Earthquakes

Life Passport Shizuoka Prefecture

First 3 Seconds Earthquake!

- Stay calm ! ● Protect yourself !
- Extinguish open flames !
- Open your door

1-2 minutes The Shaking Has Subsided

Evacuate at once from areas susceptible to landslides and tidal waves!

- Make sure that no fires have started !
- Make sure your family is all right !
- Put on your shoes !
- Take out your emergency kit !

3 minutes

- Is everyone safe ?
- Is there fire nearby ?

Shout 'KAJI' !

Use a fire extinguisher !

Help neighbors in putting out fires !

- Be careful of aftershocks !

5-10 minutes

- Turn on your radio ! **Don't be misled by fake news**
- Confirm local information reports !
- Do not use your phone as well as possible !

In the Event of an Evacuation

- Shut off your gas line! Shut off your circuit breaker !
- Do NOT evacuate by car !
- Be careful of collapsing walls, falling vending machines and signs, and glass!
- Leave a memo of where you're going in the entrance !
- Evacuate individually do not pick your children up at school !
- When you evacuate, to be careful to burglars !

10 minutes~ first Hours

- Help put out fires !
- Assist in relief efforts !

Please do basic first aid by yourself if possible !

~ Day7

- Use stocked items !

Water, Food, Radio, Flashlight, Household Medicine

- Pay attention to local announcements !
- Stay safe !
- Do not enter collapsing houses !

In the Event of an Evacuation Three Points

- Follow the instructions by local authorities !
- Abide by the rules !
- Cooperate and be considerate of those with injuries and disabilities !

Flow of Nankai Trough Earthquake Information

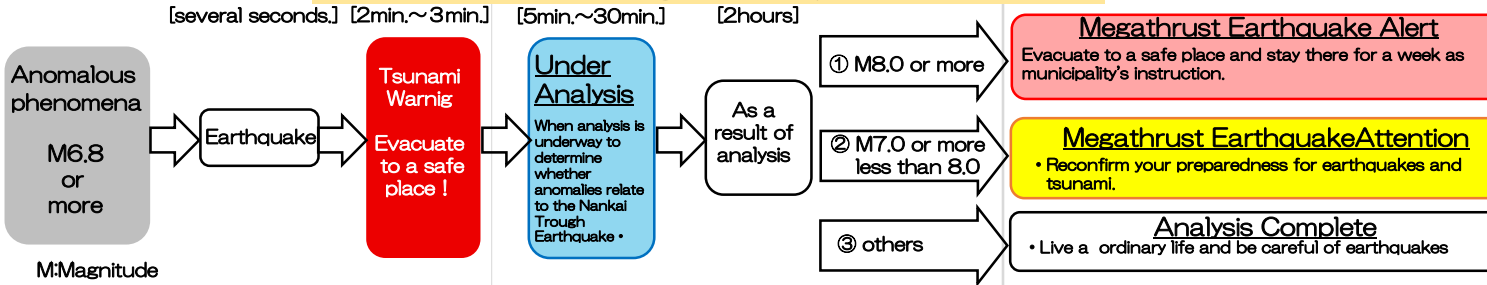

Is it necessary to evacuate from your home?

- Type of Danger (Circle one)
- ① Predicted Tsunami inundation Area
 - ② Predicted Landslide Danger Area
 - ③ Both a Tsunami and a Landslide Danger Area
 - ④ None of the above (Evacuation is not necessary)

Evacuation Site

Site Name _____

Site Location _____

Site Telephone Number _____

If you don't know the evacuation site, check with the municipal disaster prevention department or the disaster prevention app.

Your Family Plan in Case of an Earthquake or Warning Declaration

Name	Place most likely to be during the day

Emergency Family Meeting Place	Local Evacuation Site

Family contact

Name	Contact Information

NTT Disaster Emergency Message Dial to allows you to confirm friend and family

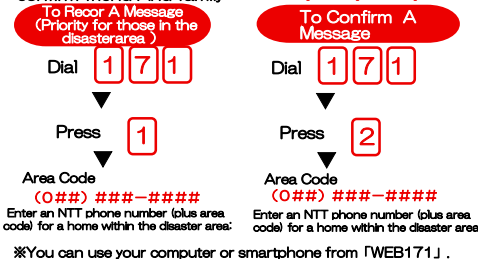

Protecting your life is yourself responsibility. Protecting your community is everyone's responsibility.

Name	
Address	
Birthdate	
Workplace Contact	
Your Volunteer Disaster Prevention Organization	

Crisis Management Department, Shizuoka Prefecture

TEL 054-221-2644
http://www.pref.shizuoka.jp/bousai/